

IA

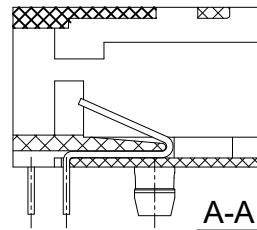

A-A

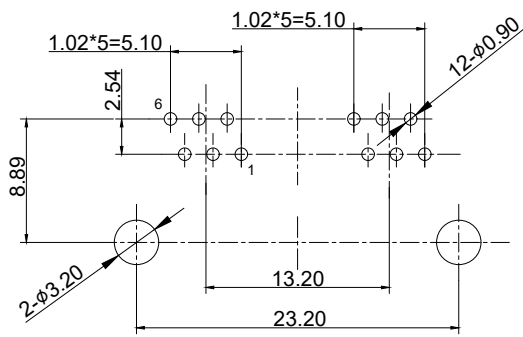
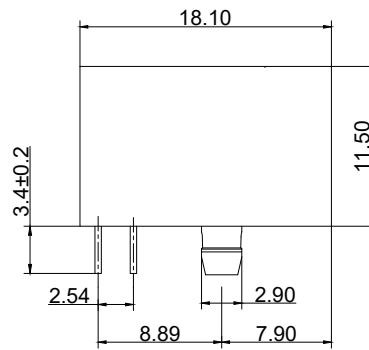
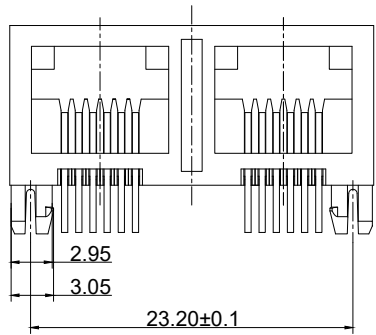

RECOMMENDED PCB LAYOUT

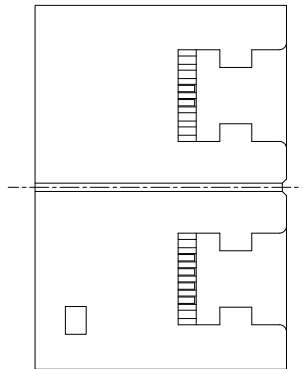

- NOTES:**
- MECHANICAL**
 - HOUSING & INSERT** : THERMOPLASTIC GLASS
FIBER FILLED UL94V-0 BLACK
 - CONTACT** : PHOSPHOR BRONZE
: GOLD PLATING AT CONTACT
AREA NICKEL PLATING
 - DURABILITY** : 750 CYCLES MIN.
 - MATING/UNMATING FORCE** : 30N / 3.06 KG MAX.
 - RETENTION STRENGTH** : 30N MIN. FOR 60S±5S
- ELECTRICAL**
- VOLTAGE RATING** : 125 VAC RMS
 - CURRENT RATING** : 1.5 AMP
 - CONTACT RESISTANCE** : 20 mΩ MAX.
 - INSULATION RESISTANCE** : 1000 MΩ MIN. AT 500V DC
 - DIELECTRIC STRENGTH** : 1000 VAC OR 1500V DC RMS
AT 0.5mA 50 Hz / 60Hz FOR
ONE MINUTE
- ENVIRONMENTAL**
- STORAGE** : -40°C ~ +85°C
 - OPERATION** : -40°C ~ +85°C

		UNIT	mm
		REVISION	04
PRODUCT		RJ11 1X2 SIDE ENTRY JACK	
DWG. NO.		PART NO.	
EZC0811-26N11-03			
PROJECTION	SCALE	SHEET	1 OF 1
		TOLERANCES	
		00~15 ± 0.15	
		15~30 ± 0.20	
		30~ ± 0.25	
		ANGLES ± 1°	