

MATERIAL

CAGE : COPPER ALLOY
 EMI SPRINGS : COPPER ALLOY
 HEAT SINK : ALUMINUM
 HEAT SINK CLIP : STAINLESS STEEL
 LIGHT PIPE : PC TRANSPARENT

PLATING

CAGE : Ni PLATING OVER ALL
 EMI SPRINGS : Ni FOR ALL
 HEAT SINK : ANODIZED

TEMPERATURE

OPERATION : -40°C~+85°C
 STORAGE : -55°C~+105°C

		UNIT	mm
		REVISION	J
PRODUCT		SFP+1X1 CAGE WITH HEAT SINK & LIGHT PIPE	
DWG NO.		PART NO.	EZSP-1PH1-01
PROJECTION	SCALE	SHEET	1 OF 2
		TOLERANCES	
		X ± 0.25 XX ± 0.13 XXX ± 0.10	
		ANGLES ± 2°	

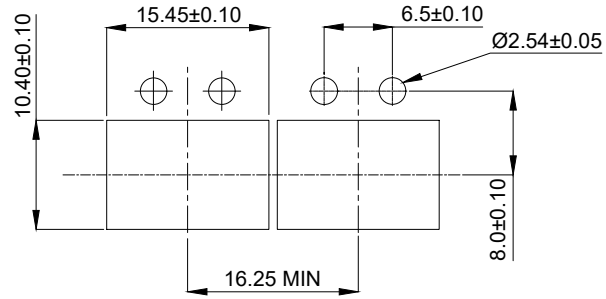

RECOMMENDED PANEL OPENING

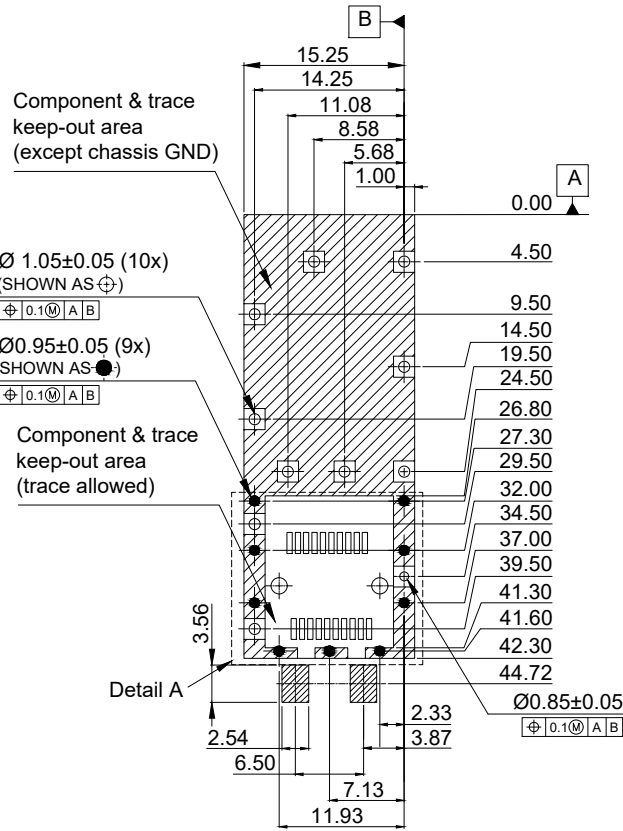
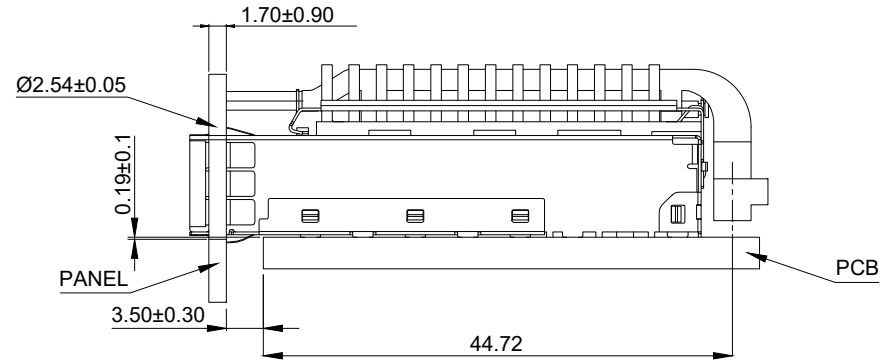

RECOMMENDED PCB LAYOUT
(PCB THICKNESS 2.37MM)

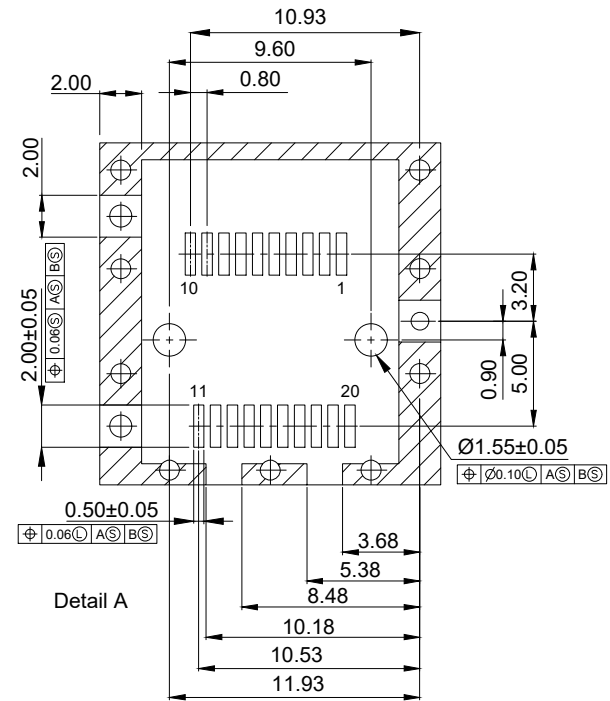

 E.S. GLOBAL TOP		UNIT	mm
		REVISION	J
PRODUCT	SFP+1X1 CAGE WITH HEAT SINK & LIGHT PIPE		TOLERANCES
DWG NO.	PART NO.	X ± 0.25 XX ± 0.13 XXX ± 0.10 ANGLES ± 2°	
PROJECTION	SCALE	SHEET	2 OF 2